

HOSETRACT

HOSE REELS

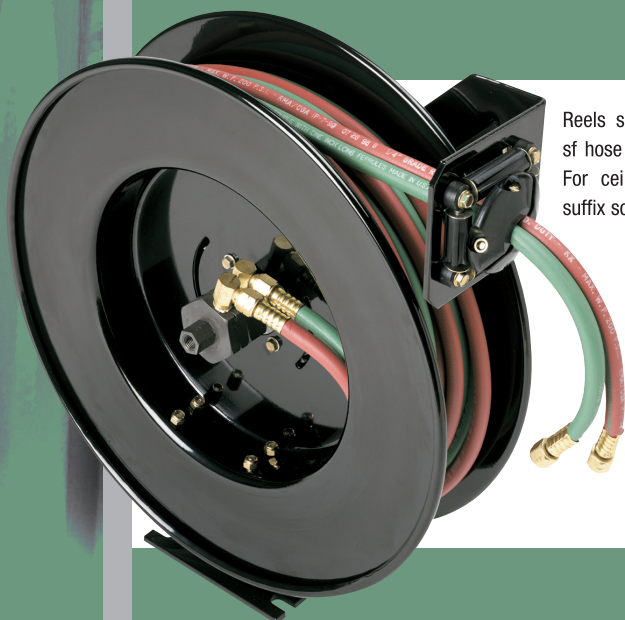

Reels shipped standard
sf hose payout position.
For ceiling mount add
suffix sc.

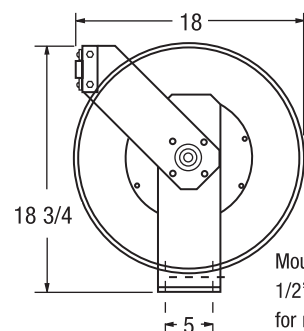
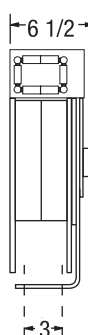

Mounting Slots
1/2" wide x 3/4" deep
for max 7/16" dia. bolt

Oxy Inlet — 1/4" FPT
Acet Inlet — 1/4" FPT

Max. Temp. — 200°F



For 1/4" Siamese Hose

Oxygen/Acetylene Hose Reel

Reel is ideally applied when space and safety is required in the welding & cutting area. The reel is capable of storing and dispensing 50' length of twin siamese welding hose.

FEATURES

- The exclusive dual hex was designed by the original designer of this dual body concept
- The major advantage of the swivel design is that in the event of an O-ring failure, the gases will go to atmosphere instead of mixing
- Safety banded drive spring
- The swivel is marked for the acetylene side with notches on the hex nuts for easy identification
- Beaded edges on spool prevents hose damage or injury to operator
- 8-position guide arm

	Model Number	Operating Pressure	Hose I.D.	Hose Length	Shipping Weight
	COA-200*	1000 PSI	1/4 IN.	—	46#
	COA-250	200 PSI	1/4 IN.	50 FT. (Twin)	54#
	UTL-200-OA*	1000 PSI	1/4 IN.	—	36#
	UTL-250-OA	200 PSI	1/4 IN.	50 FT. (Twin)	44#

COA models are the C series, heavy duty standard reels.

UTL models are the Unitract series, lighter duty reels not designed for truck mount applications.

* Models without hose.



mdi - Manufacturers Distributor, Inc | Phone: (727) 835-0669 | Fax: (813) 571-0422 | www.HosetractSales.com | sales@HosetractSales.com